

TOPOGRAPHIC DETAIL OF
PART OF LOT 17
WEST SIDE OF COLE AVENUE
REGISTERED PLAN 235
CITY OF OTTAWA

SCALE 1 : 100

J.D. BARNES LIMITED
 © COPYRIGHT 2018

NOTES

BEARINGS ARE MTM GRID AND ARE DERIVED FROM GLOBAL NAVIGATION SATELLITE SYSTEMS (GNSS) BY REAL TIME NETWORK (RTN) OBSERVATIONS, MTM ZONE 9, NAD83 (CSRS)(2010).
 FOR BEARING COMPARISONS, A ROTATION OF 4820° COUNTER CLOCKWISE CAN BE APPLIED TO BEARINGS ON BUILDING LOCATION SURVEY PLAN BY HAKENDALL SHIPMAN SURVEYING DATED NOVEMBER 20, 1984.
 DISTANCES ARE GROUND.
 ALL BUILDING TIES ARE TAKEN TO CONCRETE FOUNDATION.
 COMPLIANCE WITH ONTARIO BUILDING CODE SETBACK REQUIREMENTS ARE NOT VERIFIED BY THIS SURVEY.

LEGEND

- DENOTES SURVEY MONUMENT FOUND
 - DENOTES SURVEY MONUMENT SET
 - SSIB DENOTES STANDARD IRON BAR
 - SB DENOTES SHORT STANDARD IRON BAR
 - IB DENOTES IRON BAR
 - PB DENOTES PLASTIC BAR
 - WT DENOTES WITNESS
 - MEAS DENOTES MEASURED
 - P DENOTES REGISTERED PLAN 235
 - P1 DENOTES SURVEYORS REAL PROPERTY REPORT BY PAYETTE, HIMMA, DELORME LTD. DATED JULY 29, 1998
 - P2 DENOTES SURVEYORS REAL PROPERTY REPORT BY ANNS, O'SULLIVAN & VOLLEBEKK LTD. DATED SEPTEMBER 9, 2002
 - P3 DENOTES SURVEYORS REAL PROPERTY REPORT BY STANTEC, DATED MARCH 9, 2006
 - P4 DENOTES SURVEYORS REAL PROPERTY REPORT BY STANTEC, DATED JANUARY 27, 2015
 - P5 DENOTES SURVEYORS REAL PROPERTY REPORT BY HAKENDALL SHIPMAN, DATED NOVEMBER 26, 1984
 - D DENOTES DEED INSTRUMENT No. N350839
 - OU DENOTES ORIGIN UNKNOWN
 - ADV DENOTES ANNS, O'SULLIVAN & VOLLEBEKK LTD.
 - 647 DENOTES H.R. FARLEY, OLS
 - 657 DENOTES FAIRALL, MCFATT & WOOLAND LIMITED
 - HP DENOTES HYDRO POLE
 - CB DENOTES SINGLE CATCHBASIN
 - DENOTES GAS METER
 - DENOTES SANITARY MANHOLE
 - DENOTES STORM MANHOLE
 - DENOTES WATER MANHOLE
 - LS DENOTES LIGHT STANDARD
 - H DENOTES FIRE HYDRANT
 - WV DENOTES WATER VALVE
 - HP DENOTES SHRUB
 - HP DENOTES HYDRO POLE
 - OHU DENOTES OVERHEAD UTILITY
- N=NORTH S=SOUTH E=EAST W=WEST

ELEVATION NOTE

1. ELEVATIONS ARE GEODETIC AND ARE ESTABLISHED USING GLOBAL POSITIONING SYSTEM (GPS) EQUIPMENT TO ESTABLISH ELLIPSOIDAL HEIGHTS. ELLIPSOIDAL HEIGHTS WERE TRANSFORMED TO COVID-1928 DATUM (GEODETIC) USING THE FEDERAL HT2.0 HEIGHT TRANSFORMATION MODEL.
2. IT IS THE RESPONSIBILITY OF THE USER OF THIS INFORMATION TO VERIFY THAT THE SITE BENCHMARK HAS NOT BEEN ALTERED OR DISTURBED AND THAT ITS RELATIVE ELEVATION AND DESCRIPTION AGREES WITH THE INFORMATION SHOWN ON THIS DRAWING, 9, 2002

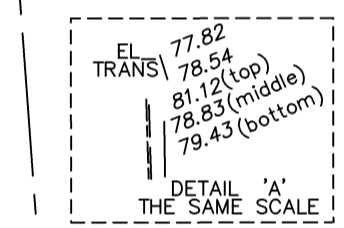

UPDATED ON JANUARY 18, 2019 FOR OVERHEAD UTILITY CABLES ELEVATIONS AND ROOF PEAK ELEVATIONS



J.D. BARNES LIMITED
 SURVEYING MAPPING GIS
 LAND INFORMATION SPECIALISTS
 2400 DON REID DRIVE, SUITE 204, OTTAWA, ON K1H 1E1
 T: (613) 731-7244 F: (613) 731-8955 www.jdbarnes.com

DRAWN BY: LH CHECKED BY: GZ DATED: 11/22/18 REFERENCE NO.: 18-10-118-00

PREPARED FOR: FALSETTO HOMES FILE: G:\18-10-118\00\18-10-118-00_TOPO.dgn PLOTTED: 1/18/2019

